

# R 267 A101

## General description

Glass fibre mesh fabrics combined with specially designed mesh surface treatments can be used in a wide range of applications.

Armouring mesh R 267 is specially designed to reinforce areas exposed to increased stress, especially a plinth. Particular fabric construction supported by special finishing meets the highest requirements in terms of strength and force absorption. Can be used both as a substitute for and in addition to other facade fabrics.

## Technical characteristics

Works Standard: 0326 Glass Fibre Mesh Fabrics

Characteristics	Units Description	R 267 A101	
		Warp	Weft
Material Linear Density	tex	136	2040
Setting	per 100 mm	23 x 2	10
Weave		half leno	
Standard Width (1)	cm individual value	100	
Roll Length (1)	m individual value	100	
Treated Fabric Thickness	mm informative value	0,95	
Loom state Fabric Weight	g/m <sup>2</sup> informative value	267	
Treated Fabric Weight	g/m <sup>2</sup> individual value, minimum	314	
Combustible Matter Content (LOI)	% of mass individual value	20	
Treatment type		alkaliresistant without emollient, obstructing yarn drifting	
Square Dimension	mm informative value	8,5 x 6,5	

(1) Other dimension on request

Tensile strength (TS) and elongation:

Minimum individual tensile strength (N/50 mm) and maximum elongation (%) when reaching minimum tensile strength is ascertained according DIN EN ISO 13934-1 as per below.

	Tensile Strength		Elongation
	Nominal value	Individual value	Average value
Standard condition	2000 / 6000	1500 / 5500	4,0 / 4,0
5 % NaOH Solution	1000 / 3500	900 / 3000	3,5 / 3,5
Fast Test	1100 / 4000	1000 / 3800	3,5 / 3,5

**Tolerances:**

Setting: ± 5 % in warp and weft  
Width: ± 1 %  
Length: ± 2 %  
LOI: ± 4 %

**Quality inspection:**

The way of quality inspection, taking of the samples and taking over of the material, is according to 0326 works standard.

**Packing:**

The rolls of fabrics are packed vertically in cardboard, on a wooden pallet. A precise method of packing is mentioned in the works standard for packing

**Storing:**

Packed rolls are to be stored in dry rooms. Storing temperature is from -10°C to +50°C

## Technical Data Sheet

### Properties

- Protect damage-risk areas
- Improves an impact resistance
- Reliable reinforcement for external facades

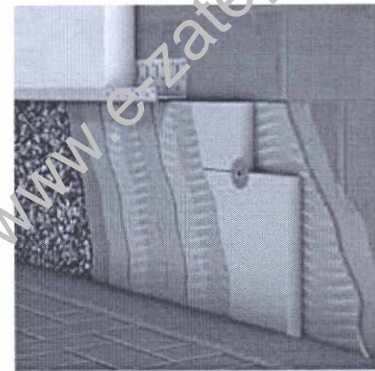

**Edited by:**

**Saint-Gobain Technical Fabrics Europe**

Saint-Gobain Vertex, s.r.o.  
Sokolovska 106  
CZ - 570 21 Litomyšl  
Tel: + 420 461 651 111  
Fax: + 420 461 612 769  
[www.sgtf.eu](http://www.sgtf.eu)

SGTF Europe reserves the right to change the information given herein without prior notice (2. Edition-25.3.2008)

Technical Data Sheet n° 45

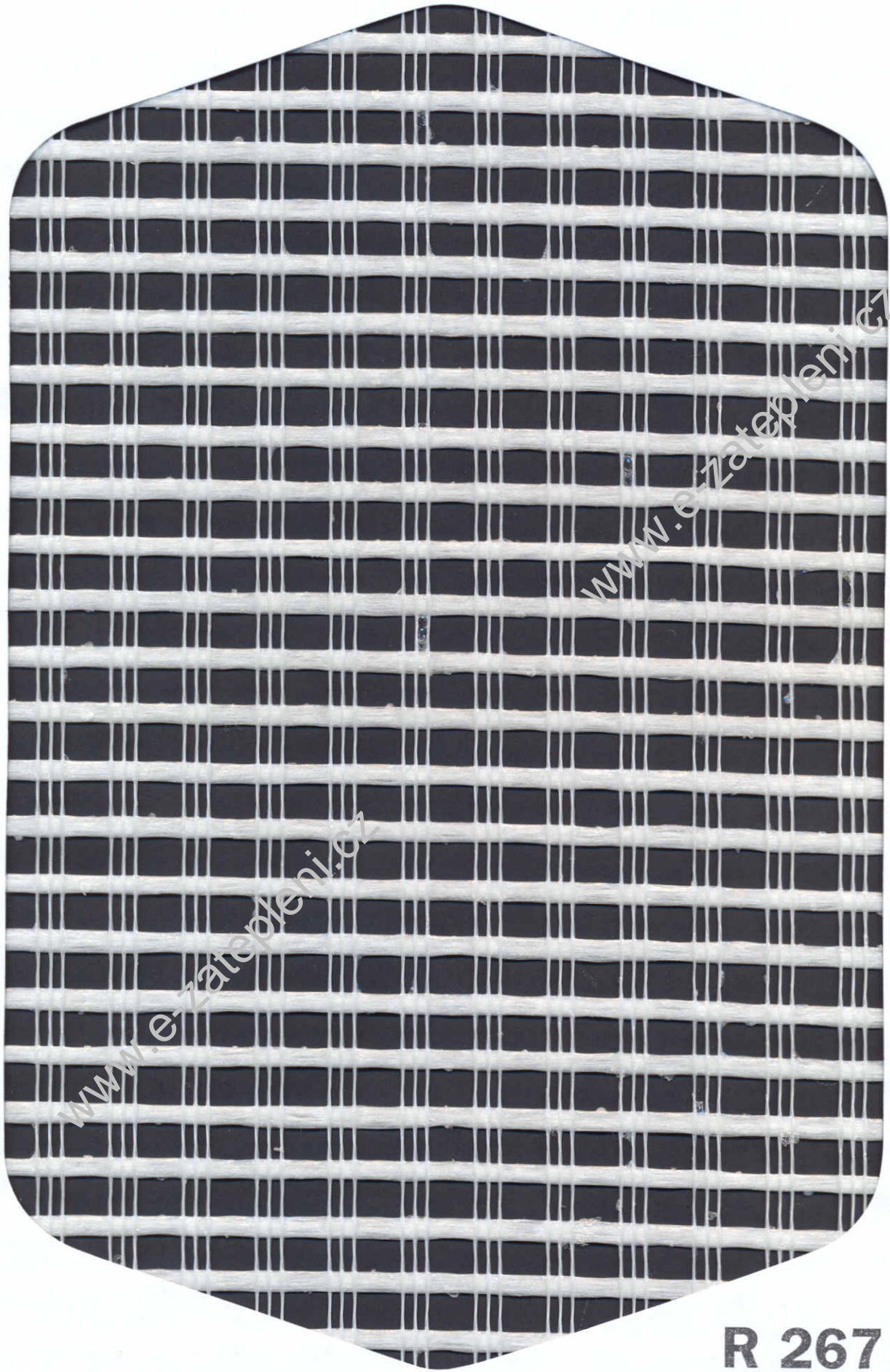

**R 267**